

Proven Performance New Modern Design



These products meet a stringent set of our company's internally defined sustainability standards¹

FDTG SERIES
Non-Condensing
Tankless Outdoor

FDTGH SERIES
Condensing
Tankless

FDTG SERIES
Non-Condensing
Tankless Indoor



FRIEDRICH

Friedrich.com/WaterHeating

PERFORMANCE YOU TRUST IN A NEW

DELIVERS THE PERFORMANCE HOMEOWNERS WANT

With the same proven performance both plumbers and homeowners trust, the Friedrich® FDTGH Series Super High Efficiency Condensing and Friedrich® FDTG Series High Efficiency Non-Condensing Tankless Water Heaters offer a new modern design. These smaller, lighter units were designed with plumbers in mind to make one-person installation and servicing even easier while saving the homeowner money and energy. Plus, enhanced features deliver the continuous hot water and dependable performance homeowners want.



EARTH-FRIENDLY EFFICIENCY, FLEXIBLE INSTALLATION

High Efficiency Performance

- Up to 1.5X the efficiency of a standard 50-gallon gas tank² – .93 UEF for condensing and .82 UEF for non-condensing
- Up to 2.5X the lifespan of a standard 50-gallon gas tank² – With the industry's most comprehensive 15-year warranty³

Sustainable Solution

- Reduces carbon footprint and energy usage – The FDTGH Series uses up to 34% less energy⁴ than a standard 50-gallon tank, while the FDTG Series uses up to 25% less⁵, helping minimize environmental impact
- Reduces greenhouse gas NOx emissions by up to 65%⁶ – Improving air quality

Flexible Upgrade

- Industry-best ½" side-to-side and front clearance to combustibles⁷ – Provides peace of mind to install in a closet and close the door
- Easy-hang front door – Slides down and hangs for easier servicing
- Faster servicing – A Phillips screwdriver is all that's needed to disassemble the unit

Smarter Solution

Built-in Wi-Fi powered by EcoNet® technology lets homeowners control and monitor their tankless water heaters from their smartphone:⁸

- Receive notifications, maintenance reminders and LeakGuard™ leak detection alerts (on select models)
- Select and adjust your temperature, turn on water saving setting, and track and compare energy consumption trends

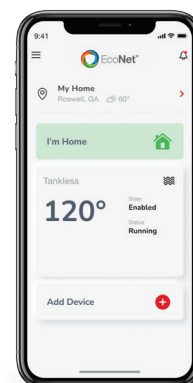

MODERN DESIGN



FRIEDRICH® FDTGH SERIES SUPER HIGH EFFICIENCY CONDENSING TANKLESS

Simplified model selection – Single unit meets almost any installation need with available outdoor conversion kit

Impressive turn down ratio – Achieve tighter control over temperature output even during lower demand

FRIEDRICH® FDTG SERIES HIGH EFFICIENCY NON-CONDENSING TANKLESS

Universal venting options – Compatible with Metal Fab, Rainbow and UBBINK standard concentric venting

Industry-leading 43' vent run capability – Easy retrofit

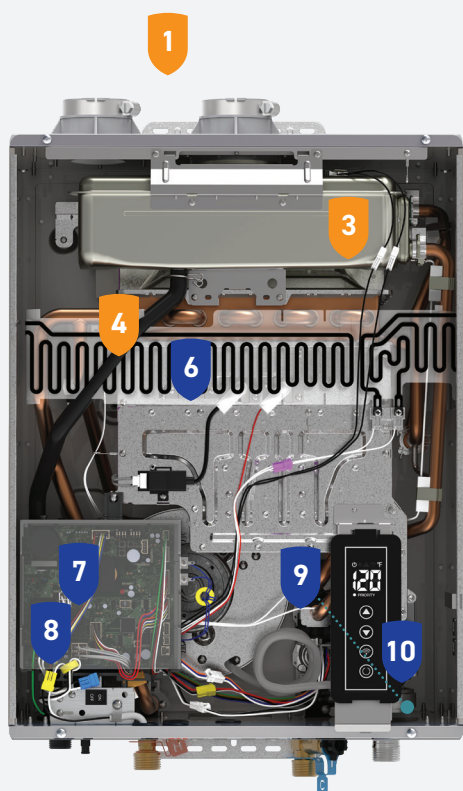

Outdoor Conversion Kit RTGH-X*

Enables FDTGH installation outdoors
(sold separately)



*When converting indoor Wi-Fi with LeakGuard models to outdoor, included cable and indoor mount should be used; This cable disables LeakGuard in outdoor installations to avoid false alarms and shut-off; Reference outdoor conversion instructions for more information on cable installation.

- 1 2" inlet & exhaust w/band connections
- 2 3"/5" concentric inlet & exhaust
- 3 Secondary stainless steel heat exchanger
- 4 Primary copper heat exchanger
- 5 Copper heat exchanger
- 6 Exclusive overheat film wrap
Protects the home
- 7 Exclusive Hot Start Programming™
Minimizes cold water bursts¹¹
- 8 Exclusive water saving feature
Saves water
- 9 LeakGuard™ with auto shut-off⁹
Detects leaks and shuts off the flow of water
- 10 Built-in Wi-Fi technology
Easy-to-use controls

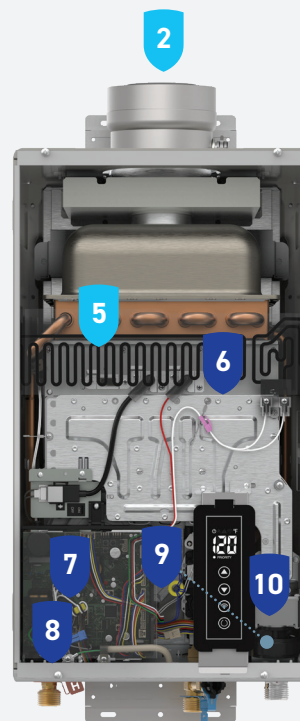

Indoor Model

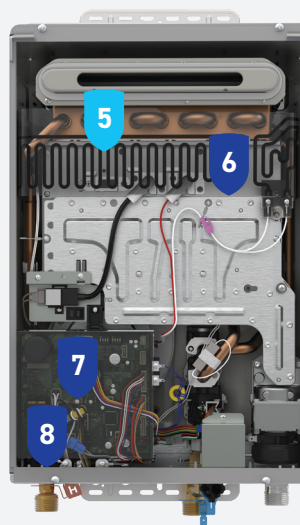

Outdoor Model

HELP YOUR CUSTOMERS START SAVING TODAY

Learn more at Friedrich.com/WaterHeating
or ask your local distributor



Friedrich® FDTGH & FDTG Series Tankless Specifications

Friedrich Model Number		FDTGH-68DVLN-3	FDTGH-84DVLN-3	FDTGH-90DVLN-3	FDTGH-95DVLN-3	FDTG-70DVLN-3	FDTG-84DVLN-3	FDTG-95DVLN-3	FDTG-70XLN-3	FDTG-84XLN-3	FDTG-95XLN-3 95XLN-3 (Wi-Fi Model)
Built-in LeakGuard™ Model Number						FDTGH-95-DVELN-3 (Wi-Fi Model)			FDTG-95-DVELN-3 (Wi-Fi Model)		
Installation Type		Indoor (Outdoor Conversion Kit sold separately: RTGH-X)				Indoor			Outdoor		
Gas Input Rate	MAX	120,000 BTU/h	157,000 BTU/h	180,000 BTU/h	199,900 BTU/h	160,000 BTU/h	180,000 BTU/h	199,900 BTU/h	160,000 BTU/h	180,000 BTU/h	199,900 BTU/h
	MIN	11,000 BTU/h	11,000 BTU/h	11,000 BTU/h	11,000 BTU/h	11,000 BTU/h	11,000 BTU/h	11,000 BTU/h	11,000 BTU/h	11,000 BTU/h	11,000 BTU/h
Uniform Energy Factor (UEF)		0.90	0.93			0.82					
Gallons Per Minute (GPM)	MAX (35°F)	6.6	8.4	9.0	9.5	7.0	8.4	9.5	7.0	8.4	9.5
	45°F Rise	5.1	6.7	7.7	8.5	6.0	6.7	7.4	6.0	6.7	7.4
	67°F Rise	3.4	4.6	5.2	5.7	4.5	5.1	5.0	4.5	5.1	5.0
Number of Bathrooms		2.5	3	3–4	4	2.5	3	3.5	2.5	3	3.5
Temp. Range		100–140°F									
Height		23.7"				24.2"			20.75"		
Width		17.7"				13.5"			13.5"		
Depth		9.8"				10.27"			9.4"		
Weight (Lbs.)		52.9				46.5			42		
Temp. Setting from Factory		120°F									
Heat Exchanger Material		Primary: Copper – Secondary: Stainless Steel				Copper					
Minimum Activation Flow		0.4 GPM									
Minimum Continuous Flow		0.26 GPM									
Maximum Altitude		7,800 ft.									
Ultra Low NOx		Meets 14 ng/J NOx requirements – SCAQMD Rule 1146.2 compliant									
Warranty		15-Year Heat Exchanger 5-Year Parts 1-Year Labor									

NOTE: All models are available in Natural Gas or Propane (LP). For Propane replace the N with P for LP model.

CONTACT US

**Customer Service,
Warranty and Parts:**
800-621-5622

Technical Service:
800-HEATER3
(800-432-8373)

EcoNet® Support:
800-255-2388

**Plumber Support
Group:**
866-339-2388



¹Sustainability Standouts are Wi-Fi models only. ²Based on comparison of a Friedrich FDTG/FDTGH Series model against a standard residential 50-gallon tank type model with like fuel type. ³Based on comparison of Friedrich FDTG/FDTGH series models against similar models from leading tankless competitors. ⁴Based on reduction in energy usage of Friedrich FDTG/FDTGH Series models with a 0.93 UEF compared to a standard residential atmospheric 50-gallon tank type model with a 0.61 UEF. Assumes like fuel type, not to exceed 75,000 BTU. ⁵Based on reduction in energy usage of FDTG Series models with a 0.82 UEF compared to a standard residential 50-gallon tank type model with a 0.61 UEF. Assumes like fuel type, not to exceed 75,000 BTU. ⁶Based on comparison of Friedrich FDTG/FDTGH Series model against standard residential 50-gallon tank type model with like fuel type, not to exceed 75,000 BTU. ⁷Based on comparison of Friedrich FDTG/FDTGH Series models against similar models from leading tankless brands. ⁸Applies only to models with Wi-Fi; Wi-Fi broadband connection and EcoNet® App required; notifications are dependent on external factors beyond our control. ⁹Available on select models only. ¹⁰Based on responses from a 2021 quantitative study of 614 US water heating professionals. ¹¹Based on a comparison of Friedrich FDTG/FDTGH Series models having the Hot Start Programming™ against consumer reviews of leading competitor models.

Printed in the USA • 11/24 • QG • Form No. TK-FDTG/FDTGH-3-BR